

VRLA Battery

- completely sealed and maintenance-free, low self-discharge
- 100% precise quality testing, stable quality and high reliable performance
- Unique grid alloy formula and updated manufacturing technique
- Floating & standby use: up to 8 years
- Cycle use 1: More than 240 cycles at 100% DOD
- Cycle use 2: More than 1200 cycles at 30% DOD



Application:

- Telecommunications
- UPS/EPS
- DC Power Supply
- Solar system
- Wind Power System
- Auto Control System

Construction:

- ComponentRaw material
- PositiveLead dioxide
- NegativeLead
- ContainerABS
- CoverABS
- SealantEpoxy
- Safety valveRubber
- TerminalCopper/Pb
- SeparatorFiber glass
- Electrolyte Sulfuric acid

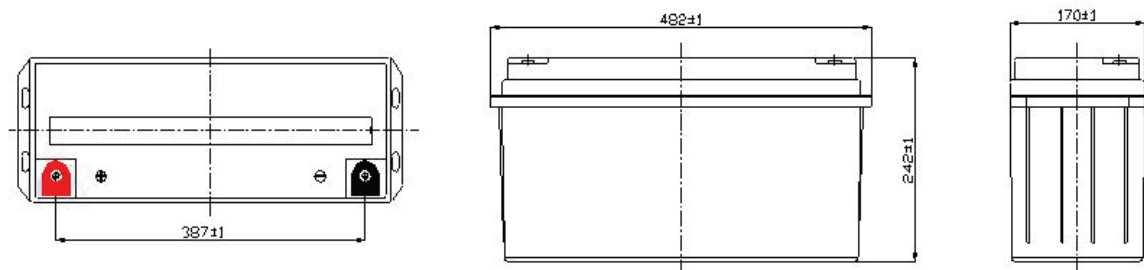
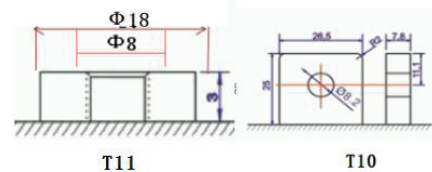

Specification:

Battery Model	12V150AH			
Designer Floating Life	Up to 8 Years			
Capacity (25°C)	20HR(7.65A,10.5V)	10HR(15A,10.8V)	1HR(82.5A,9.6V)	
	153.0AH	150AH	82.5AH	
Dimensions	Length	Width	Height	Total Height
	482mm (19.0inch)	170mm (6.69inch)	242mm (9.9.53inch)	242mm (9.53inch)
Approx. Weight	41Kg (90.36 lbs)			
Internal Resistance	Full charged at 25°C: ≤3mΩ			
Self Discharge	2% of capacity declined per month at (25°C)			
Capacity Affected by Temp.(10HR)	40°C	25°C	0°C	-15°C
	102%	100%	85%	65%
Charge Voltage(25°C)	Cycle use		Float use	
	14.4-15.0V(-18mV/°C), max. Current: 45.0A		13.5-13.8V (-18mV/°C)	

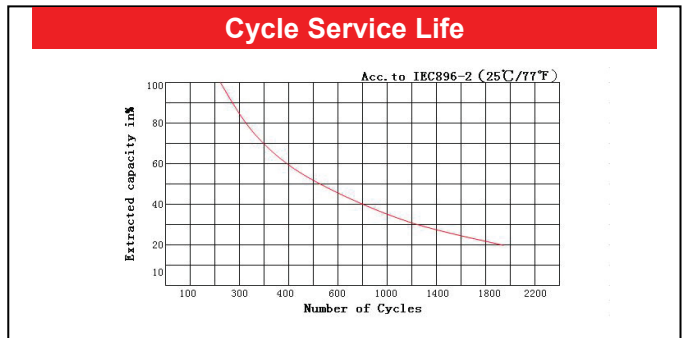
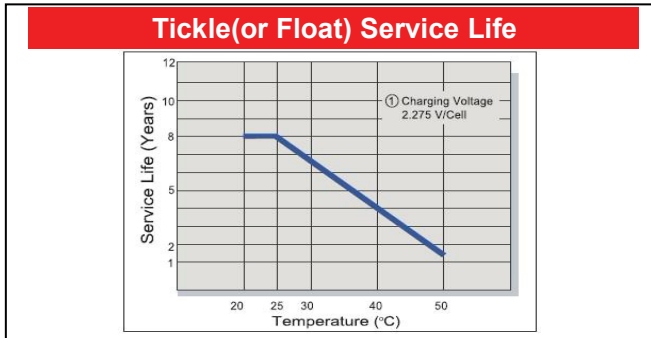
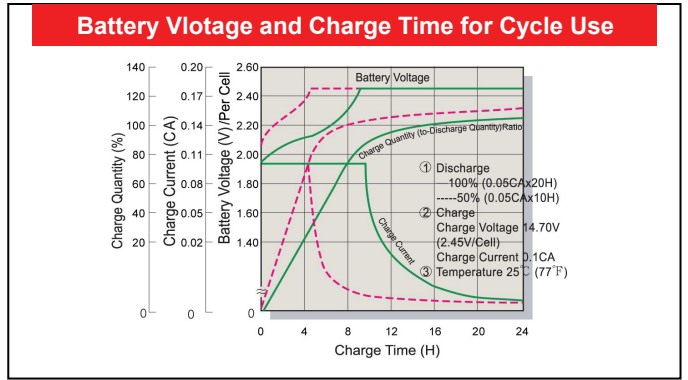
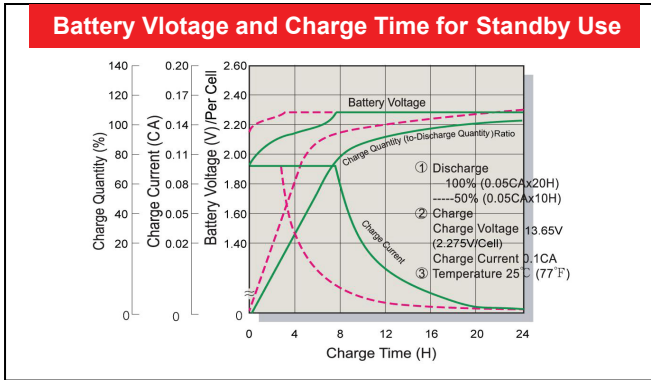
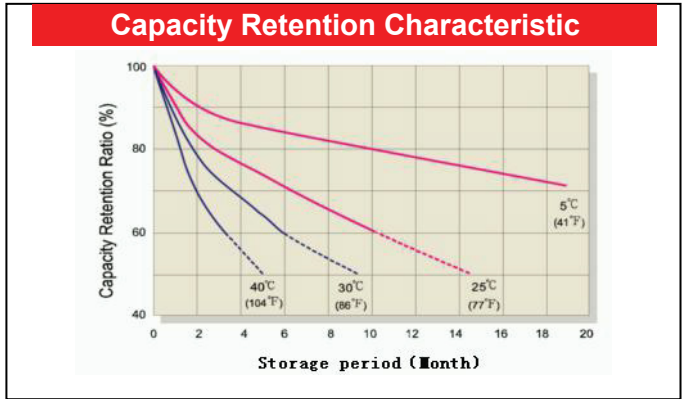
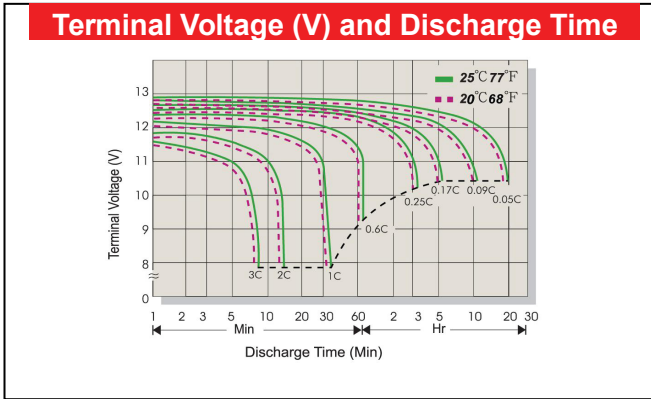

Constant Current Discharge(CC,Unit:A) at 25°C(77°F)											
F.V/Time	5Min	10Min	15Min	27Min	1Hr	2Hr	3Hr	4Hr	5Hr	10Hr	20Hr
9.6V	375	300	255	150	82.5	52.5	37.7	30.0	25.7	15.4	7.68
10.2V	370	295	253	148	82.3	52.2	37.5	29.7	25.5	15.3	7.67
10.5V	365	290	251	146	82.1	51.9	37.3	29.4	25.3	15.2	7.65
10.8V	360	285	249	144	81.9	51.6	37.0	29.1	25.0	15.0	7.60
Constant Power Discharge (CP,Unit:W) at 25°C(77°F)											
F.V/Time	5Min	10Min	15Min	27Min	1Hr	2Hr	3Hr	4Hr	5Hr	10Hr	20Hr
9.6V	3750	3000	2550	1500	825	525	377	300	257	154	76.8
10.2V	3700	2950	2530	1480	823	522	375	297	255	153	76.7
10.5V	3650	2900	2510	1460	821	519	373	294	253	152	76.5
10.8V	3600	2850	2490	1440	819	516	370	291	250	150	76.0